

# Office to let

## Globalworth Campus Building 1

Bucharest, Sector 2, 9 Dimitrie Pompeiu Blvd.

### Building information

Building status	Existing
Year of construction	2010
Parking ratio	1 / 80 sq m
Total building area	29 000 sq m

### Commercial terms

Office space*	after login *
Parking	after login *
Service charge*	after login *
Minimum lease term	after login *
Availability	after login *

\* Asking terms for m<sup>2</sup>/month

### Location

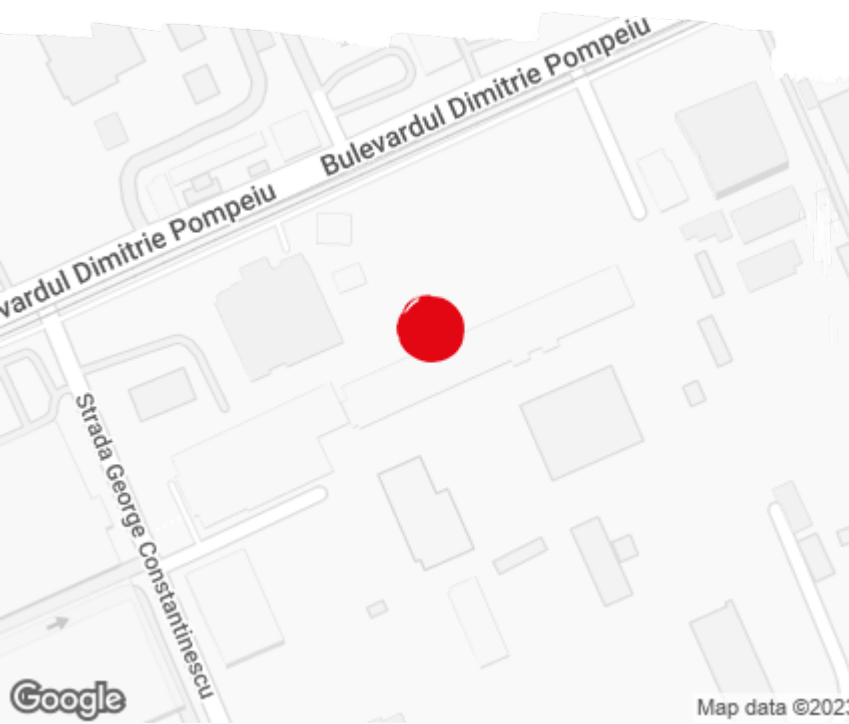

### Available space

1 440 sq m

Available office space

500 sq m

Minimum office space

## Typical floor plan

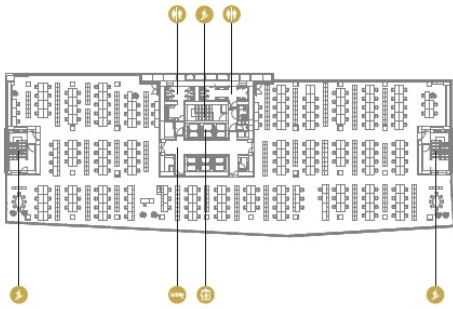

## Available space

Floor	Vacant space	Availability
8	please contact us *	please contact us *
Total	after login *	

## Public transport

Metro: M2  
Bus: N125  
Tram: 16, 36

## Contact



+40 21 302 3400

More information